

"Термосистемы" г. Краснодар

8-800-301-02-65

info@teploobmennik-russia.ru
www.teploobmennik-russia.ru

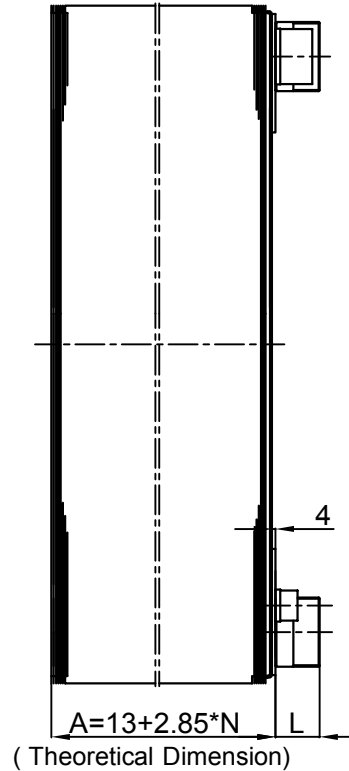
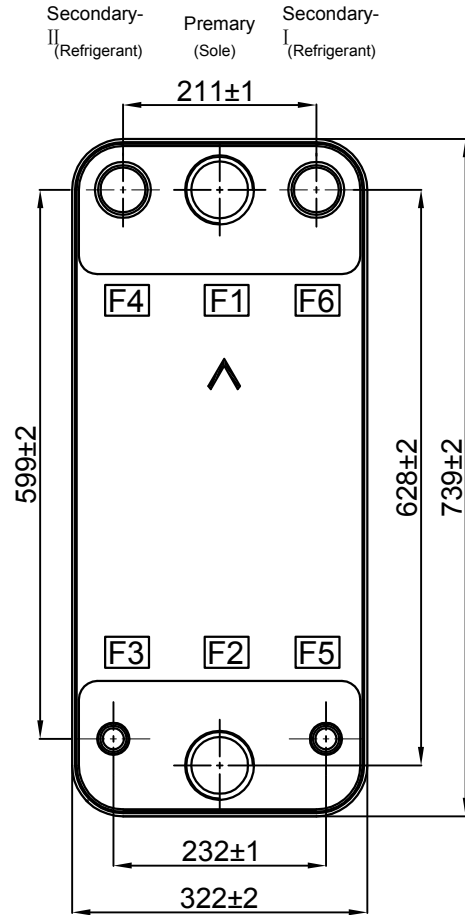

Standard Connections:							
Size	Length	F1	F2	F3	F4	F5	F6
External Thread : <input type="checkbox"/> R; <input type="checkbox"/> G; <input type="checkbox"/> NPT;							
1"1/4	L=24mm	<input type="checkbox"/>	<input type="checkbox"/>	<input type="checkbox"/>	<input type="checkbox"/>	<input type="checkbox"/>	<input type="checkbox"/>
1"1/2	L=30mm	<input type="checkbox"/>	<input type="checkbox"/>	<input type="checkbox"/>	<input type="checkbox"/>	<input type="checkbox"/>	<input type="checkbox"/>
2"	L=48mm	<input type="checkbox"/>	<input type="checkbox"/>		<input type="checkbox"/>		<input type="checkbox"/>
2"1/2	L=48mm	<input type="checkbox"/>	<input type="checkbox"/>				
3"	L=52mm	<input type="checkbox"/>	<input type="checkbox"/>				
Internal Thread: <input type="checkbox"/> NR; <input type="checkbox"/> NG; <input type="checkbox"/> NNPT;							
1"1/4	L=40mm	<input type="checkbox"/>	<input type="checkbox"/>	<input type="checkbox"/>	<input type="checkbox"/>	<input type="checkbox"/>	<input type="checkbox"/>
1"1/2	L=40mm	<input type="checkbox"/>	<input type="checkbox"/>	<input type="checkbox"/>	<input type="checkbox"/>	<input type="checkbox"/>	<input type="checkbox"/>
2"	L=48mm	<input type="checkbox"/>	<input type="checkbox"/>		<input type="checkbox"/>		<input type="checkbox"/>
2"1/2	L=48mm	<input type="checkbox"/>	<input type="checkbox"/>				
Solder Connections:							
1"1/8(Ø28.7mm)	L=24mm	<input type="checkbox"/>	<input type="checkbox"/>	<input type="checkbox"/>	<input type="checkbox"/>	<input type="checkbox"/>	<input type="checkbox"/>
1"3/8(Ø35.3mm)	L=24mm	<input type="checkbox"/>	<input type="checkbox"/>	<input type="checkbox"/>	<input type="checkbox"/>	<input type="checkbox"/>	<input type="checkbox"/>
1"5/8(Ø42.1mm)	L=30mm	<input type="checkbox"/>	<input type="checkbox"/>	<input type="checkbox"/>	<input type="checkbox"/>	<input type="checkbox"/>	<input type="checkbox"/>
2"1/8(Ø54.1mm)	L=40mm	<input type="checkbox"/>	<input type="checkbox"/>		<input type="checkbox"/>		<input type="checkbox"/>
2"5/8(Ø67mm)	L=52mm	<input type="checkbox"/>	<input type="checkbox"/>				
3"1/8(Ø79.5mm)	L=52mm	<input type="checkbox"/>	<input type="checkbox"/>				
Back plate internal thread: <input type="checkbox"/> NR; <input type="checkbox"/> NG; <input type="checkbox"/> NNPT;							
1/2"	L=24mm	<input type="checkbox"/> H1 ;	<input type="checkbox"/> H2 ;				
Other Connections on Inquiry!							

No. of Plates	30	40	50	60	70	80	90	100	110
Weight Empty (kg)	37.6	45.8	54	62.2	70.4	78.6	86.8	95	103.2
Heat transfer area(m ²)	5.88	7.98	10.08	12.18	14.28	16.38	18.48	20.58	22.68

No. of Plates	120	130	140	150	160	170	180	190	200
Weight Empty (kg)	111.4	119.6	127.8	136	144.2	152.4	160.6	168.8	177
Heat transfer area(m ²)	24.78	26.88	28.98	31.08	33.18	35.28	37.38	39.48	41.58

Approvals: CE, UL, other approvals on inquiry

Brazen Plate Heat Exchanger			Design conditions	
Model	Plates Channel	Solder	Design Pressuer(MPa)	Design Temperature(°C)
SNB210HD	<input type="checkbox"/> HDQ;	Copper	<input type="checkbox"/> 3.0; <input type="checkbox"/> 4.5	-196~+200 °C
Attention: Connections can reduce the design limits				

							Plate material: 316L;	
							SNB210HD	
Mark No.	Change file No	sign	Date				SNB210HD-EN	
Design	Standard			View	Scale	Size		
Check	Approved				1 : 8			
Review	Edition							
Process	Date							